











**LEGEND**

-  3WATT LED DOWNLIGHT
-  3WATT LED DOWNLIGHT c/w EMERGENCY INVERTER
-  MAINTAINED 2D 10WATT BULKHEAD IP65 RATED
-  2D 28WATT DOWNLIGHT
-  2D 28WATT DOWNLIGHT c/w EMERGENCY INVERTER
-  600x600mm MODULAR LUMINAIRE
-  600x600mm MODULAR LUMINAIRE c/w EMERGENCY INVERTER
-  1200mm TWIN FLUORESCENT FITTING
-  MAINTAINED DIRECTIONAL EMERGENCY EXIT SIGN
-  LIGHT SWITCH (No. OF GANGS AS INDICATED)
-  2 WAY LIGHT SWITCH
-  PULL CORD LIGHT SWITCH
-  DISTRIBUTION BOARD

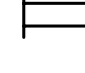
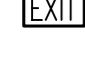
**NOTES:**

1. LIGHT SWITCH c/w NEON INDICATOR TO MANUALLY OPERATE THE CANOPY LUMINAIRES ADJACENT MAIN ENTRANCE.
2. LIGHTING IN PLANT AREAS BY SPECIALIST.
3. ALL CIRCUITS SERVING LED DOWNLIGHTERS TO BE CONTACTOR CONTROLLED. COIL TO BE OPERATED VIA A SINGLE LIGHT SWITCH LOCATED IN MAIN SWITCHROOM.
4. 2-CHANNEL TIMESWITCH TO OPERATE ALL CORRIDOR & STAIRCASE LIGHTING. CHANNEL 1 TO OPERATE ALL STAIRCASE LUMINAIRES & 50% OF CORRIDOR LUMINAIRES. CHANNEL 2 SHALL OPERATE REMAINING 50% OF CORRIDOR LUMINAIRES. TIME SETTINGS TO BE AGREED WITH END USER UPON COMPLETION.
5. LIGHT SWITCH c/w NEON INDICATOR TO OPERATE ROOF VOID LIGHTING CIRCUITS.

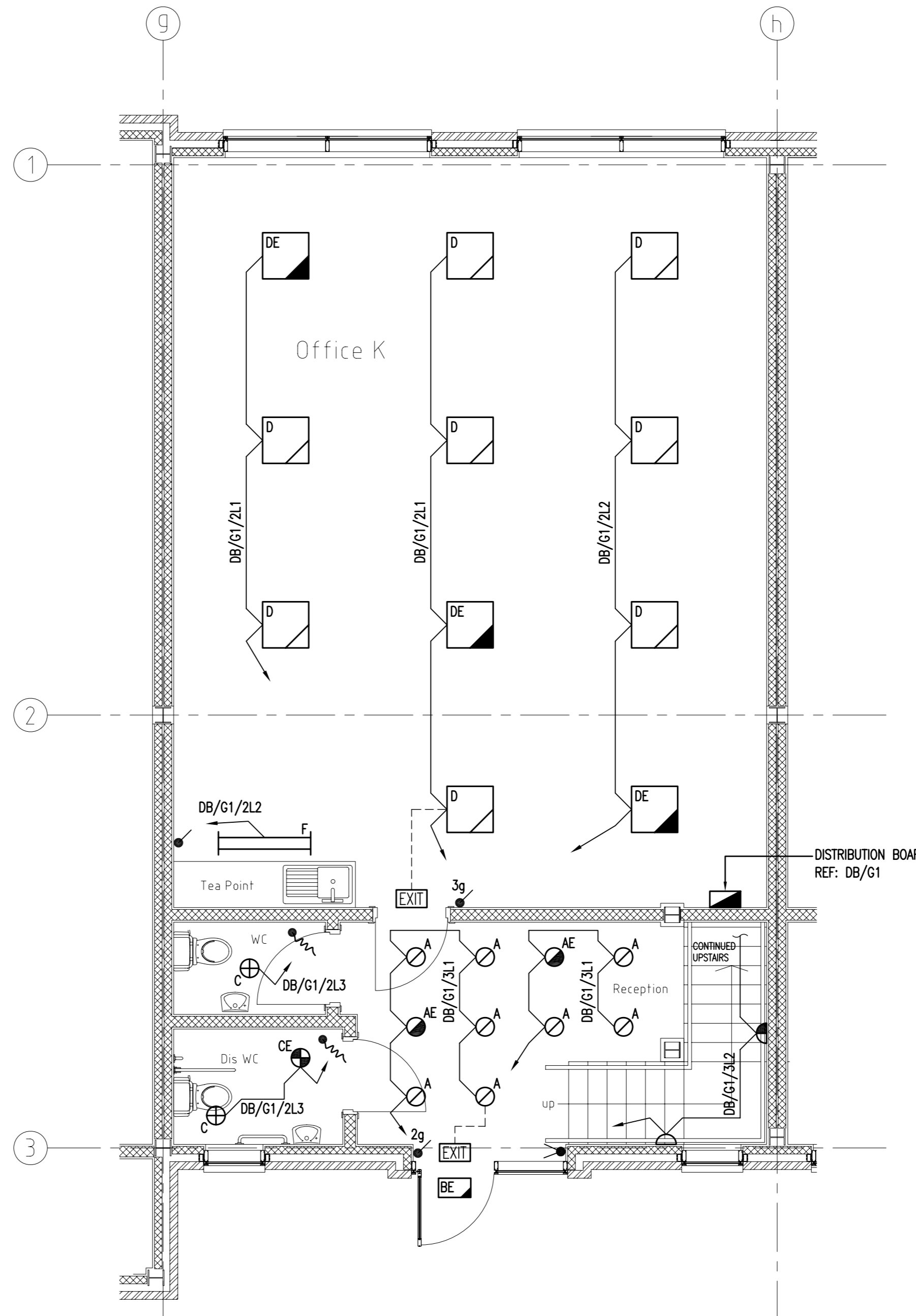
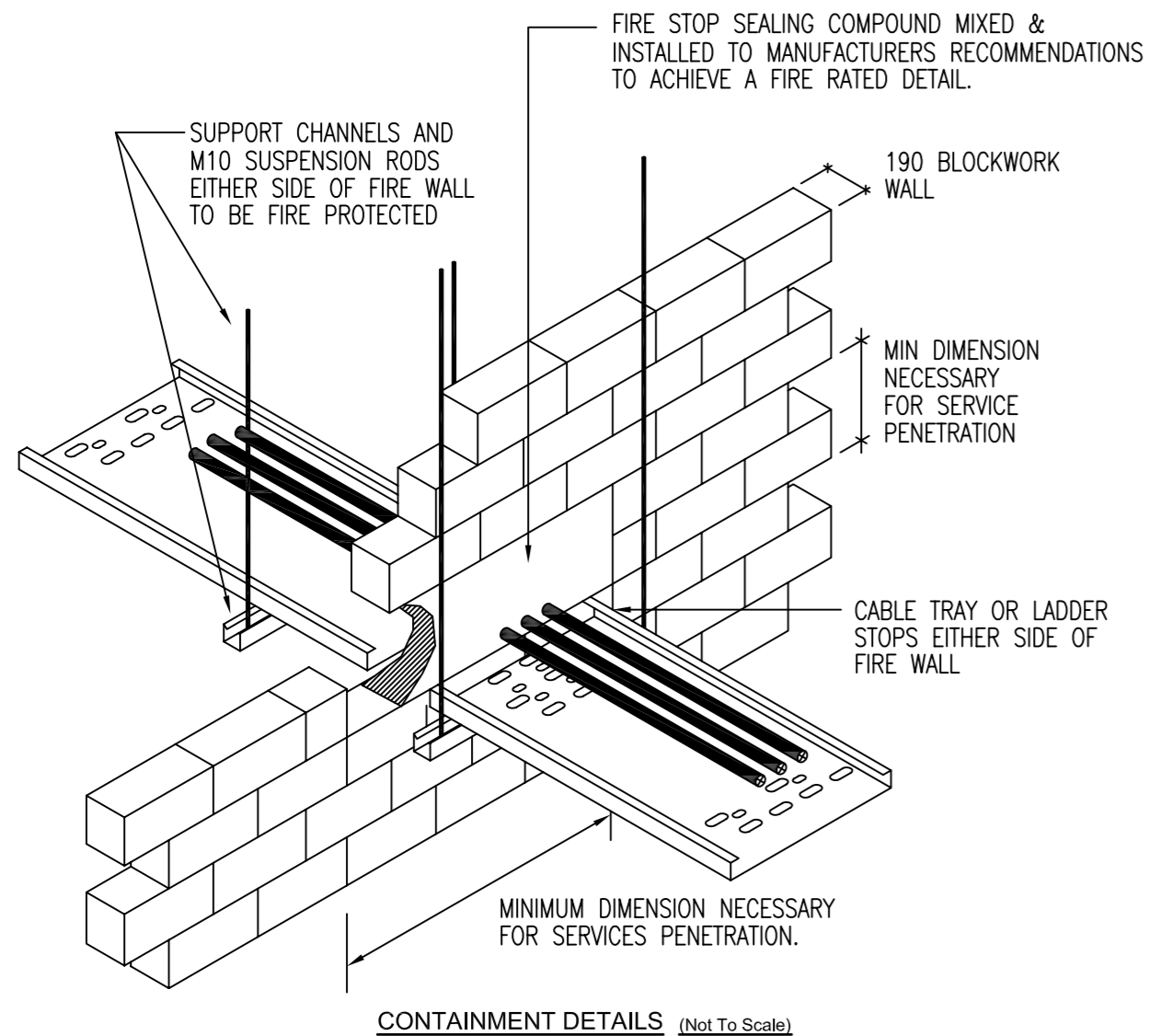

Rev	Date	Description	By
A	12/08/08	ARCHITECTURAL LAYOUT REVISED	AH

**CONSTRUCTION**

Client  
S.C.H. PROPERTIES Ltd.

Job Title  
MERLIN TECHNOLOGY PARK READING

Drawing Title  
OFFICE K GROUND FLOOR LIGHTING & EMERGENCY LIGHTING LAYOUT

Drawn	Scale	Checked
Alcad	1:50@A2	P.S.
Date	Client Ref.	Approved
05/07/08	SCH1	M.W.

**ALCAD**  
*Draughting Services*  
29 Instone Road Halesowen West Midlands B63 4SA  
Tel: 07973 117873 Fax: 07970 764146 Email: alan@alcad.co.uk

Drawing No.	Issue
1704/E01	A
Job No.	1704-E01.dwg
SCH03/2008	